



Mindray Veterinary Anesthesia Machine Introduction

Ver. 2019

2019-04

mindray

About Mindray

A Global View of Mindray Anesthesia

NORTH VISTA HOSPITAL, A7 X 6 units
HOLY CROSS HOSPITAL, A7 X 18 units
NORTH SHORE MEDICAL CENTER, A7 X 12 units
NORTH VISTA HOSPITAL, A7 X 6 units
St. Vincent's Health System, A5 X 13 units
Lee Memorial Health System, A5 X 13 units
Emory University Hospital, A5 X 9 units
New York Community Hospital of Brooklyn, A5 X 1+ units
...

Hopital Prive De L'Ouest Parisia - France
Nouvelle Clinique Bel Air - France
Hopital Europeen De Paris Roseaie - France
Blaye Hospital - France
Kom Kreiskliniken Günzburg-Krumbach - Germany
Privat Hospital Equipe - Holland
Clouchestershire Hospitals NHS trust - UK
Casa Di Cura Figlie di San Camillo - Italy

140+ Countries

40000+ units*

*Including human and veterinary products

mindray

Mindray Veterinary Anesthesia Product

WATO Series Anesthesia System



WATO EX-20Vet
Veterinary anesthesia machine



WATO EX-35Vet
Veterinary anesthesia workstation

Specification Overview



WATO EX-20Vet

WATO EX-20Vet	Model	WATO EX-35Vet
7.0 inch color screen Key + Knob	Screen	10.4 inch touch screen Key + Knob
Mechanical control, Two tubes Low flow range: 0-1 L/min, High flow range: 1-15 L/min	Flow meter	Mechanical control, Two tubes Low flow range: 0-1 L/min, High flow range: 1-15 L/min
1.5 L	CO2 canister	1.5 L
Max 2 vaporizer position	Vaporizer	Max 2 vaporizer position
20-1500 ml	Tidal volume	20-1500 ml (Standard) 5-1500 ml (Opt, w/ PCV-VG)
VCV, PCV, SIMV –VC/PC, PSV, Spontaneous	Vent Mode	VCV, PCV, SIMV –VC/PC, PSV, PCV-VG, Spontaneous
Opt: O2	Gas monitoring	Opt:O2, Plug&Play CO2, Multi-Gas module
Rebreathing circuit, Non-rebreathing circuit , (opt: ACGO)	Breathing circuit	Rebreathing circuit, Non-rebreathing circuit , (opt: ACGO)
4 wheel brakers	Brake	4 wheel brakers
1	Drawer	3
/	Smart Alarm Management	Yes



WATO EX-35Vet

Why Mindray Anesthesia System?



Fully automatic inhalation anesthetic solution for Veterinary

Intelligence ventilator

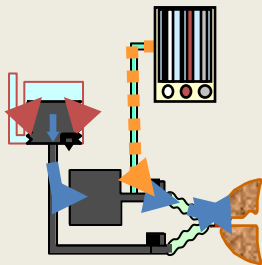

What you set is what you get

Precise Vaporizer



FDA Approval
Maintenance free for
life span

Complete Monitoring



Respiratory status &
gas monitoring

Why Mindray Anesthesia System?



Fully automatic inhalation anesthetic solution for Veterinary



Integrated breathing system

Less Leakage, Quick switch,
Heating



Intuitive user interface

Simple and Clear



System leakage test

Quick start and direct
result display



Waste gas scavenging

Quick start and direct
result display



Ergonomics Design

Large worksurface and
ease to move

WATO EX-20Vet

WATO EX-20Vet



Model	WATO EX-20Vet
Screen	7.0 inch color screen Key + Knob
Flow meter	Mechanical control, Two tubes Low flow range: 0-1 L/min, High flow range: 1-15 L/min
CO2 canister	1.5 L
Vaporizer	Max 2 vaporizer position
Tidal volume	20-1500 ml
Vent Mode	VCV, PCV, SIMV –VC/PC, PSV, Spontaneous
Gas monitoring	Opt: O2
Breathing circuit	Rebreathing circuit, Non-rebreathing circuit , (opt: ACGO)
Brake	4 wheel brakers
Drawer	1

WATO EX-20Vet Overview



Auxiliary O2 flow meter*

Fresh gas flow meter

Gas supply gauge

Breathing system circuit

System switch

Breathing bag connector

CO2 canister

7.0 inch screen

Work Light*

Vaporizer

Handle

ACGO*

Drawer

Wheel brakes

*Optional

mindray

Intelligence ventilator

Safety

Ease to use

- **Electronic control ventilator that allows users to choose the modes best fit for the veterinary needs**

- ✓ VCV-Volume control ventilation, the most common used ventilation mode
- ✓ PCV- Pressure control ventilation, useful for animals with pulmonary disease or unnormal compliance
- ✓ SIMV/PS*- Synchronized Intermittent Mandatory Ventilation, balance between spontaneous breath and minimal mechanical ventilation support
- ✓ PSV*- Pressure support ventilation, for animals with spontaneous breath
- ✓ PEEP – positive end-expiratory pressure, avoid alveolar collaps during surgery

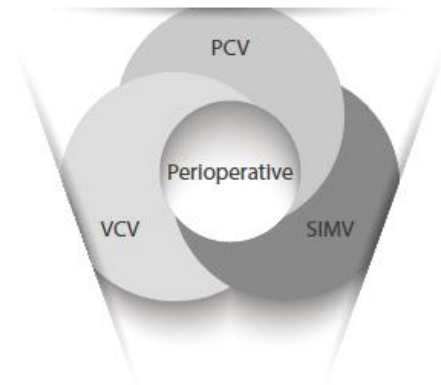

*Optional

Intelligence ventilator

Safety

Ease to use

- **FlowSecure™ Patent Technology, What you set is what you get**

- ✓ Dynamic tidal volume compensation, prevent the influence of fresh gas flow or system compliance & leakage
- ✓ High-quality insp & exp flow sensors, precise and long service life
- ✓ Internal the 3rd flow sensor for calibration and safety backup

- **Full range precise tidal volume without changing bellows**

- ✓ Do not have to change bellows by animals' size, improve routine workflow
- ✓ Tidal volume down to 20ml (VCV) or 5ml(PCV), apply to tiny animals



One bellows from 20ml-1500ml

VS



Two bellows:
small : 20-300ml ; Large: 300-1500ml

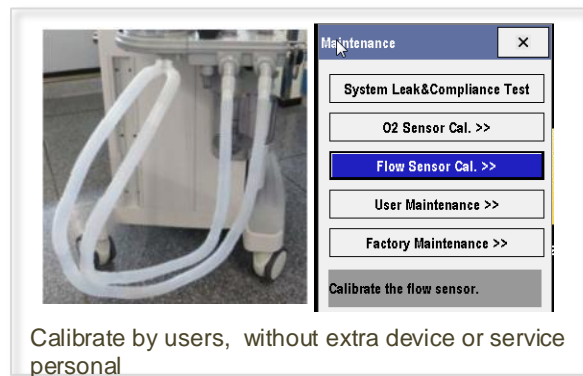
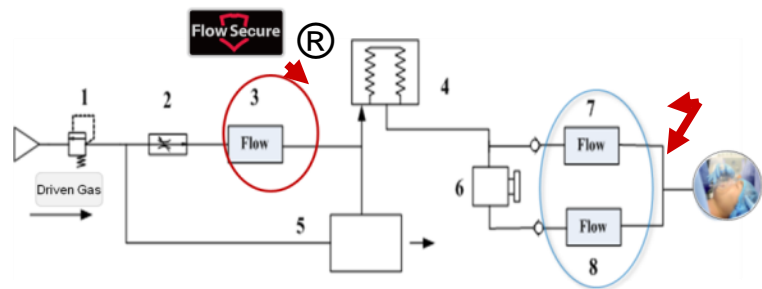

Calibrate by users, without extra device or service personal

mindray

Complete Monitoring & Alarm

Safety

Ease to use

- **Physiological monitoring**

- ✓ Waveform: Airway Pressure , Flow, Volume
- ✓ Monitoring Parameters: PEAK ,MEAN, PEEP, TV, MV, Rate

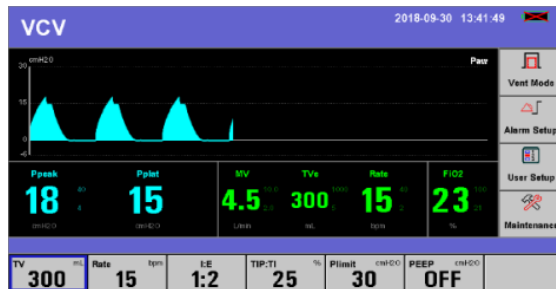

- **Alarm management system**

- ✓ Indicate the alarm cause by words directly, help to troubleshoot quickly, avoid damage of animals.
- ✓ Centralized alarm limit setting, including apnea, pressure, tidal volume, insp O2 concentration.
- ✓ Important system malfunction prompt: gas supply failure, power supply failure, circuit disconnection

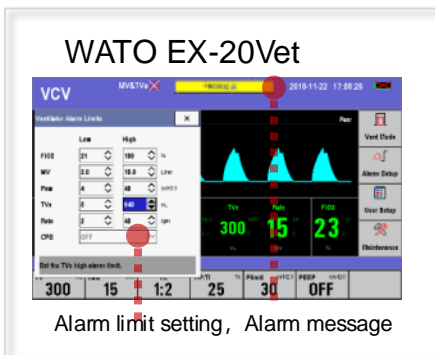

VS

Others



Only notice LED for limited alarms, hard to read and solve problem.

mindray

Maintenance-free Vaporizer

Safety

Ease to use

- Vaporizer

- Mindray V60 vaporizer (Iso, Sev, Hal)

- ✓ Automated flow/ Temp/ Pressure compensation ensure a constant output and accurate concentration under different environment conditions.
- ✓ Good air-tightness, reduce agent gas waste
- ✓ **Maintenance-free** design ensure that no calibration is required throughout the entire life span
- ✓ **FDA Approval**
- ✓ Large capacity (300 ml with most wick, 360 ml with dray wick)
- ✓ Highly compatible: support three different filling options and standard selectatec mounting system.

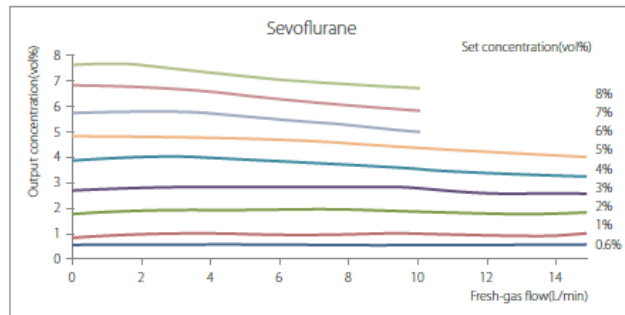

The diagrams show the influence of flow on the concentration delivered after 1 minute at 22°C, 101.3 k Pa when operating with Air.

Integrated Breathing System

Safety

Ease to use

- **Non-redundant tubes and cables**

- ✓ Avoid system leakage, reduce agent cost
- ✓ Avoid disconnection, mis-connection and intertwine
- ✓ Save the space in the operation room

Integrated breathing system
WATO EX-20Vet



VS

Non-integrated breathing system

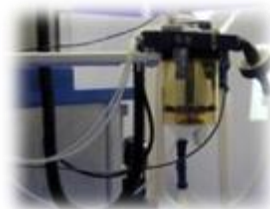

Messy and hard to use



Integrated Breathing System

Safety

Ease to use

- **Quick switch between Manual ventilation & Auto ventilation**

- ✓ Start ventilator quickly in emergence situation
- ✓ Without changing tubes
- ✓ Precise control of maximum airway pressure by APL valve
- ✓ Ensure the safety of animal



WATO EX-20 Vet

VS



Others: Need replace the breathing bag with tubes

- **Quick switch between rebreathing circuit and non-rebreathing circuit**

- ✓ Independent ACGO port
- ✓ Control by mechanical switch directly without inserting and extracting tubes
- ✓ Non-rebreathing circuit: for tiny animals down to 3-5kg



Independent ACGO port



Non-rebreathing circuit

mindray

Integrated Breathing System

Safety

Ease to use

- **Heating* for whole breathing system**

- ✓ Reduce the condensate water,
- ✓ Avoid the conflutination of bellows and valves
- ✓ Ensure the stable monitoring of flow sensors, ensure the stable of ventilation
- ✓ **Warmer gas into the animals' lung, decrease the heat loss during surgery**

Breathing system with Heating module



VS

Breathing system without Heating module



Condensate water

- **CO2 caniter with large capacity**

- ✓ 1.5L volume, for larger animals or prolonged surgery
- ✓ Transparent material, clear to observe the absorbent color.
- ✓ Ease to disasesmble, without tools
- ✓ Non-cover design, refill absorbent directly
- ✓ Autocalvable (up to 134 °C)



Intuitive User Interface

- 7.0 inch color TFT screen
- Flat-design UI, pop-up menu, Simple and Clear
- Button + Knob, The common operation needs less than 3 steps
- Provide waveforms and monitoring parameters including Flow, Volume, Pressure
- **Provide important physiological and technical alarms, ensure animals' safety during surgery**
- **Record the trend and logs during surgery for review**
- **Automatic system leakage test**

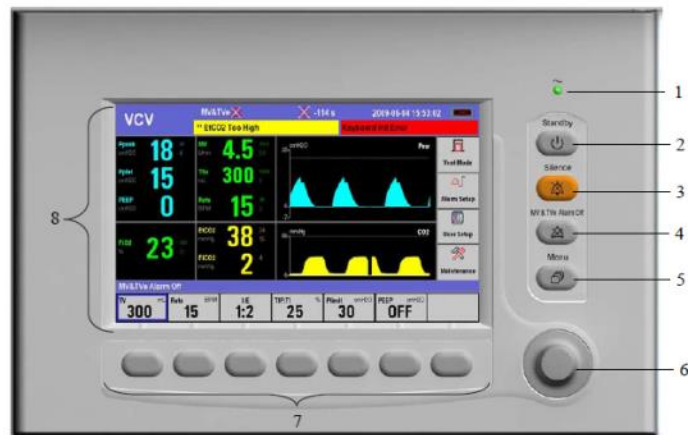

1 AC power LED

5 Menu

2 Standby

6 Control knob

3 Alarm Silence

7 Ventilator parameter setup quick keys

4 MV&Tve alarm off

8 Display screen

Intuitive User Interface

Safety

Ease to use

- Record the trend and logs during surgery for review

Time	TVe mL	RV L/min	Ppeak cmH ₂ O	Pplat cmH ₂ O	Pmean cmH ₂ O	PEEP cmH ₂ O
09:58:00	---	---	---	---	---	---
09:57:30	---	---	---	---	---	---

Trend Table

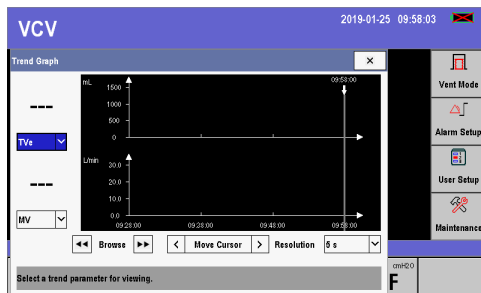

Trend Graph



Animal anesthesia record

System leakage test

Safety

Ease to use

- **Automatic system leakage test, keep the users safe**
- ✓ **Simple**: One button start after operating as the instructions, without other interventions.
- ✓ **Quick**: Less than 30s to finish the test
- ✓ **Complete**: Automatic circuit leak test (ventilator) & Manual circuit leak test (breathing bag)

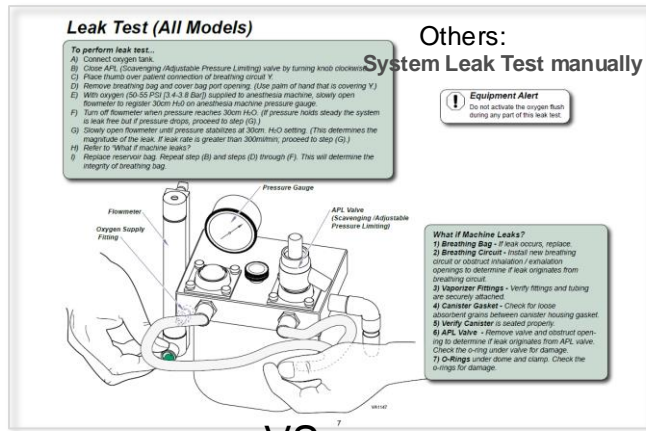

VS
WATO EX-20Vet

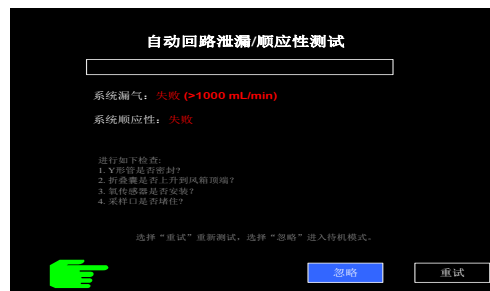
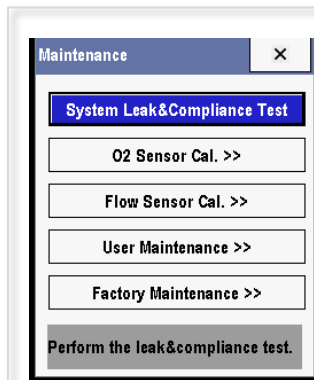

Waste gas scavenging system

Safety

Ease to use

- Two optional type of waste gas scaventing system
- Reduce OR pollution and ensure the veterinarians health
- ✓ Passive AGSS
- ✓ Active AGSS



Passive AGSS



Active AGSS

Ergonomics Design

Safety

Ease to use

- **Ergonomics Design**
- Handles for remove and extra device installation
- Drawer with large capacity for storage, e.g. Tubes, masks, etc



WATO EX-35Vet

WATO EX-35Vet



Model	WATO EX-35Vet
Screen	10.4 inch touch screen Key + Knob
Flow meter	Mechanical control, Two tubes Low flow range: 0-1 L/min, High flow range: 1-15 L/min
CO2 canister	1.5 L
Vaporizer	Max 2 vaporizer position
Tidal volume	20-1500 ml (Standard) 5-1500 ml (Opt, w/ PCV-VG)
Vent Mode	VCV, PCV, SIMV -VC/PC, PSV, PCV-VG, Spontaneous
Gas monitoring	Opt:O2, Plug&Play CO2, Multi-Gas module
Breathing circuit	Rebreathing circuit, Non-rebreathing circuit, (opt: ACGO)
Brake	4 wheel brakers
Drawer	3
Smart Alarm Managment	Yes

WATO EX-35Vet Overview



Intelligence ventilator

- **Electronic control ventilator that allows users to choose the modes best fit for the veterinary needs**

- ✓ VCV-Volume control ventilation, the most common used ventilation mode, tidal volume down to 20 mL
- ✓ PCV- Pressure control ventilation, useful for animals with pulmonary disease or unnormal compliance
- ✓ SIMV/PS*- Synchronized Intermittent Mandatory Ventilation, balance between spontaneous breath and minimal mechanical ventilation support
- ✓ PSV*- Pressure support ventilation, for animals with spontaneous breath
- ✓ PCV-VG* – Pressure control volume guarantee, avoid barotrauma and volutrauma, tidal volume can be set down to 5 mL
- ✓ PEEP – positive end-expiratory pressure, avoid alveolar collapse during surgery

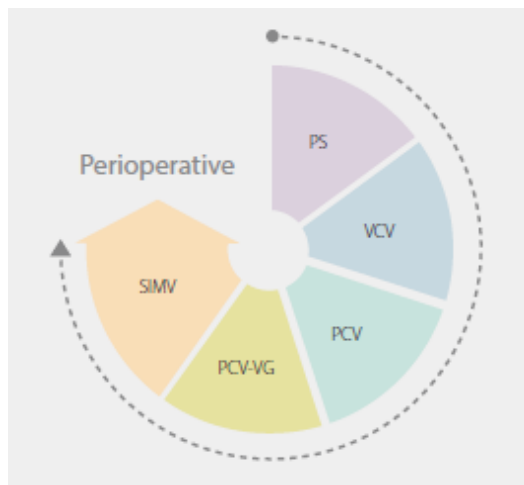

*Optional

● **FlowSecure™ Patent Technology, What you set is what you get**

- ✓ Dynamic tidal volume compensation, prevent the influence of fresh gas flow or system compliance & leakage
- ✓ High-quality insp & exp flow sensors, precise and long service life
- ✓ Internal the 3rd flow sensor for calibration and safety backup

- **Full range precise tidal volume without changing bellows**

- ✓ Do not have to change bellows by animals' size, improve routine workflow
- ✓ Tidal volume down to 20ml (VCV) or 5ml(PCV), apply to tiny animals

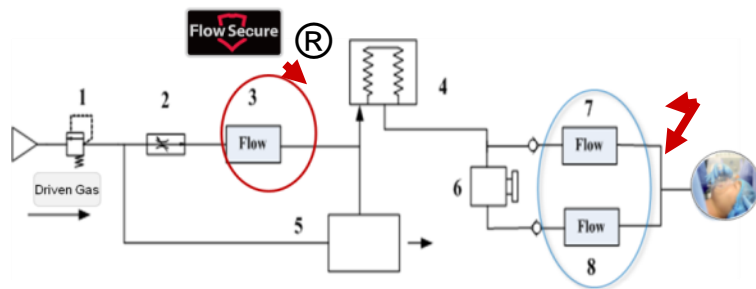

VS



One bellows from 20ml-1500ml

Two bellows:
small : 20-300ml ; Large: 300-1500ml



Complete Monitoring

Safety

Ease to use

- **Integrated plug-in & play CO2 and Anesthetic Gas module*, ensure animals safety during surgery**
- ✓ Module design, sharing with Patient monitors, reduce purchase cost
- ✓ CO2 module
 - ✓ Inspiratory and expiratory CO2 concentration, CO2 waveform
- ✓ AG module
 - ✓ Paramagnetic O2 sensor, maintenance-free
 - ✓ Identify 5 agent gases and N2O, CO2, O2
 - ✓ ☐ FiCO2 & EtCO2, FiO2 & EtO2, FiN2O & EtN2O, FiAA & EtAA

*Optional



Maintenance-free Vaporizer

Safety

Ease to use

- Vaporizer

- Mindray V60 vaporizer (Iso, Sev, Hal)

- ✓ Automated flow/ Temp/ Pressure compensation ensure a constant output and accurate concentration under different environment conditions.
- ✓ Good air-tightness, reduce agent gas waste
- ✓ **Maintenance-free** design ensure that no calibration is required throughout the entire life span
- ✓ **FDA Approval**
- ✓ Large capacity (300 ml with most wick, 360 ml with dray wick)
- ✓ Highly compatible: support three different filling options and standard selectatec mounting system.

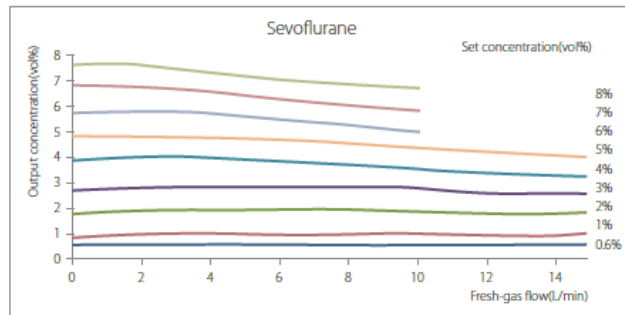

The diagrams show the influence of flow on the concentration delivered after 1 minute at 22°C, 101.3 k Pa when operating with Air.

Integrated Breathing System

Safety

Ease to use

- **Non-redundant tubes and cables**

- ✓ Avoid system leakage, reduce agent cost
- ✓ Avoid disconnection, mis-connection and intertwine
- ✓ Save the space in the operation room

Integrated breathing system
WATO EX-35Vet



VS

Non-integrated breathing system

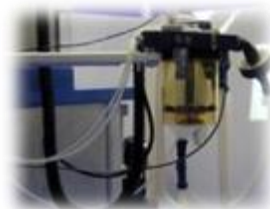

Messy and hard to use



Integrated Breathing System

Safety

Ease to use

- **Quick switch between Manual ventilation & Auto ventilation**

- ✓ Start ventilator quickly in emergence situation
- ✓ Without changing tubes
- ✓ Precise control of maximum airway pressure by APL valve
- ✓ Ensure the safety of animal



WATO EX-35 Vet

VS



Others: Need replace the breathing bag with tubes

- **Quick switch between rebreathing circuit and non-rebreathing circuit**

- ✓ Independent ACGO port
- ✓ Control by mechanical switch directly without inserting and extracting tubes
- ✓ Non-rebreathing circuit: for tiny animals down to 3-5kg



Non-rebreathing circuit

mindray

Integrated Breathing System

Safety

Ease to use

- **Heating* for whole breathing system**

- ✓ Reduce the condensate water,
- ✓ Avoid the conflutination of bellows and valves
- ✓ Ensure the stable monitoring of flow sensors, ensure the stable of ventilation
- ✓ **Warmer gas into the animals' lung, decrease the heat loss during surgery**

Breathing system with Heating module
WATO EX-35Vet



VS

Breathing system without Heating module



Condensate water

- **CO2 caniter with large capacity**

- ✓ 1.5L volume, for larger animals or prolonged surgery
- ✓ Transparent material, clear to observe the absorbent color.
- ✓ Ease to disassemble, without tools
- ✓ Non-cover design, refill absorbent directly
- ✓ Autoclavable (up to 134 °C)
- ✓ Three kinds of caniter choosed by necessary

Non-pre-pak w/o bypass



Non-pre-pak w/ bypass



Pre-pak w/ bypass



mindray

Intuitive User Interface

- 10.4 inch **touchscreen**, resolution 1024X768
- Operation principle: Touchscreen & Knob & hard keys
- Flat UI design, **the common operation need less than 2 steps**
- Maximum 3 waveforms at the same time
- Waveforms and Loops* display simultaneously
- Provide important physiological and technical alarms, ensure animals' safety during surgery
- **Smart alarm management with text and graphical instruction, help to solve problem quickly.**
- **Record the trend and logs during surgery for review**
- **Automatic system leakage test**

*Optional



Intuitive User Interface

Safety

Ease to use

- **Smart alarm management**

- ✓ Indicate the alarm cause and remedy by words and pictures, help to troubleshoot quickly, avoid damage of animals.
- ✓ Centralized alarm limit setting, including apnea, pressure, tidal volume, insp O2 concentration, etc.
- ✓ Important system malfunction prompt: gas supply failure, power supply failure, circuit disconnection, etc

- **Record the trend and logs during surgery for review**

Quick Alarm Limit Setting



Graphical troubleshoot



List Trend



Graphical Trend



Event Log



Animal anesthesia record

System leakage test

Safety

Ease to use

- **Automatic system leakage test, keep the users safe**

- ✓ **Simple**: graphical instructions, with least user interventions.
- ✓ **Quick**: Less than 30s to complete each item and 120s in total
- ✓ **Complete**: Power-on test (Hardware), preoperative checklist, Automatic circuit leak test (ventilator) & Manual circuit leak test (breathing bag)

1 Power-on self test



2 Preoperative check list

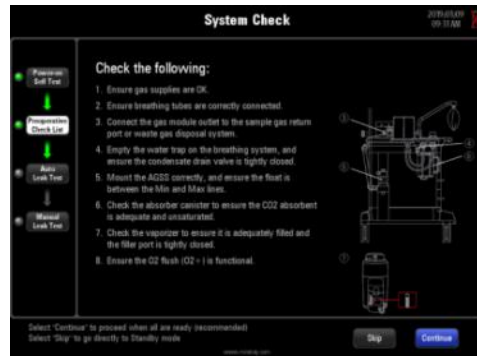

3 Auto Leak Test

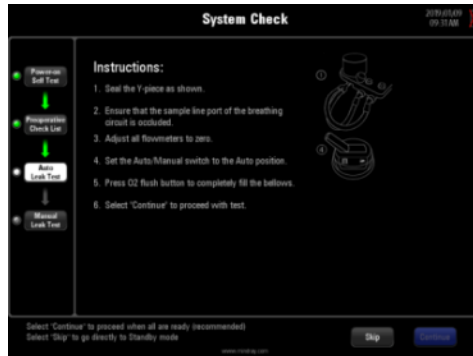

4 Manual Leak Test

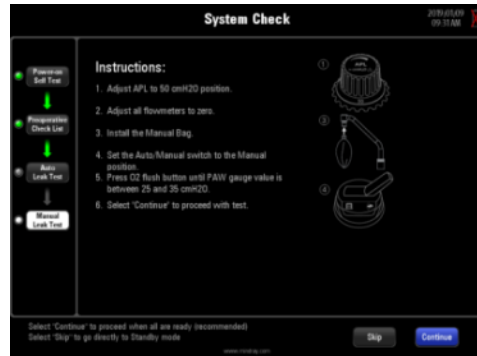

Waste gas scavenging system

Safety

Ease to use

- Two optional type of waste gas scaventing system
- Reduce OR pollution and ensure the veterinarians health
- ✓ Passive AGSS
- ✓ Active AGSS



Passive AGSS



Active AGSS

Ergonomics Design

Safety

Ease to use

- **Ergonomics Design**
- ✓ Handles for remove and extra device installation
- ✓ Large worksurface
- ✓ Drawer with large capacity for storage, e.g. Tubes, masks, etc



Take Home Message

Why Mindray Anesthesia System?

Safety

Intelligence ventilator

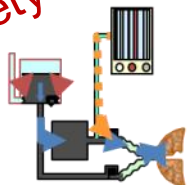

What you set is what you get

Precise Vaporizer



FDA Approval
Maintenance free for life span

Complete Monitoring



Respiratory status & gas monitoring

Fully automatic inhalation anesthetic solution for Veterinary

Only by
Mindray

Ease to use



Integrated breathing system

Less Leakage , Quick switch , Heating



Intuitive user interface

Simple and Clear



System leakage test

Quick start and direct result display



Waste gas scavenging

Quick start and direct result display



Ergonomics Design

Large worksurface and ease to move

mindray

Thank you!

mindray